

# **Hemingford Road: House Histories. 2**

## **Even Numbers: Romsey Mill - 112**

**First owner of plot; Date Built; Original Building Plan; First Recorded Occupiers**  
**Allan Brigham: 2012**

### **To Show**

1. Development per Plot Owner - House or group of houses that were built, with picture of house or group in 2012. The Plot Owner & Builder were often, but always, not the same person.
2. Portrait Pictures: Residents in 2012 living in each house or group of houses.
  - House number shown for those not available to be photographed.
3. Year Built. Dates shown are:
  - Building Plan
  - First evidence that house has been built, normally from Census or Street Directories.
4. Owner when built if known.
5. Original Building Plans: Source CRO.
6. House Pictures: Each house, with information about occupier from Street Directory (Head of Household or 'Garden'), or first recorded Census.

.....

### **A work in progress**

This was written as a book for the 'Hemingford & Romsey Roads Street Party' in 2012. My thanks to everyone who spoke to me, and to those who invited me into their houses and their lives, especially Jean Turner, Margaret Squires, Brian Thompson, and the Nightingale family. I'm very grateful for help from the staff at Romsey Mill, The Cambridgeshire Collection, to Mike Petty, and to the staff at Cambridgeshire Archives who have only recently archived the early Building Plans and who could not have been more helpful. I am indebted to Hemingford Road resident Soo Martin for turning my photographs of the plans into images everyone can enjoy.

Neither the early Census returns nor the Building Plans were given street numbers. I have hopefully ascribed the correct Census details or Plan to the right house, but I may be wrong. An updated copy of this book will be deposited in The Cambridgeshire Collection.

### **Sources:**

All dates from Street Directories unless specified

### **Abbreviations**

**BP** Building Plan

**C** Census

**D** Deeds

**LV** Land Valuation

**SI** Street Improvement Map, 1897

### **Photos:**

**2012 Photos:** Allan Brigham

**Building Plans:** Courtesy of Cambridgeshire Record Office. Please ask for permission to reproduce

# Hemingford Rd: *Romsey Mill* (former Methodist Chapel)



**Chapel:**

**Built:**

**1891 (BP & Foundation Stone)**

**Owner: Trustees of Wesleyan Chapel  
(BP)**



**BP: 14.10.1891**

**Plans for Chapel for Chapel**

**Trustees. Sec: Wm Jacob**

**Plans by: New, William, Pleasant  
Villa, Mount Pleasant**

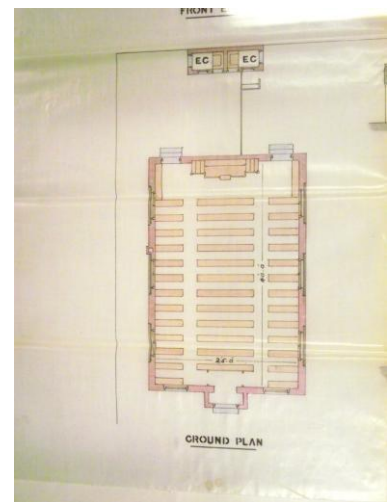

**Chapel:**

**Built: 1906**

**(BP & Foundation Stone)**

**Owner: Trustees of  
Wesleyan Chapel (BP)**



**BP: 19.4.1906**

**Plans for Chapel for Chapel**

**Trustees Treasurer:**

**Kerridge, Charles, Hill Av**

**Plans by:**

**New, Wm, 10. Castle St**

# Hemingford Rd: Hemingford House



**1911 c**

Bailey, Henry      Blacksmith      68      Hd      Suffolk,  
Redgrave

Bailey, Ruth      49      Wife m.5yrs      Cambs,  
Harston

Wheeler, Albert H      School      11      Stepson      Cambridge

**Note: Ruth Bailey – See Note: No 6 Hemingford Rd.**

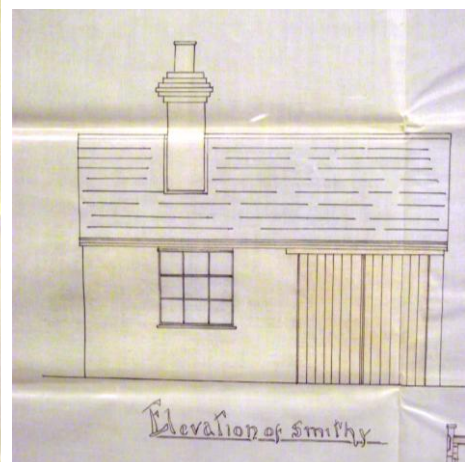
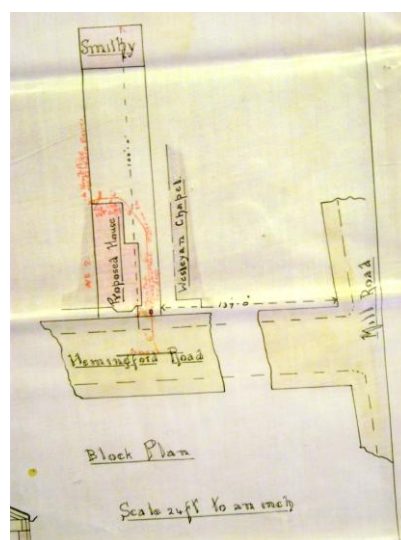

BP: 14.6.1905 House + Smithy for Henry Bailey



# Hemingford Rd: 2-4-6.

## *Fern Cottages*

Built: 1889 (BP) -1901c  
Owner: WJ Webb 1889 BP

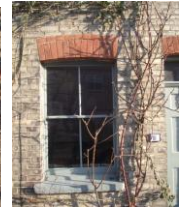
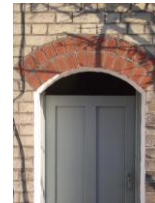

6

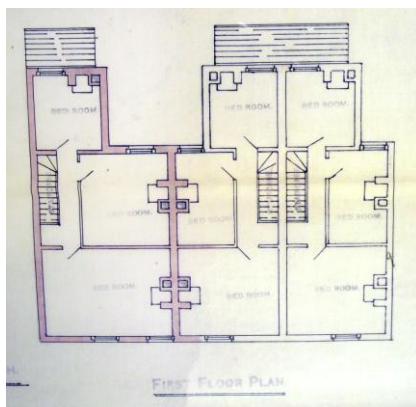
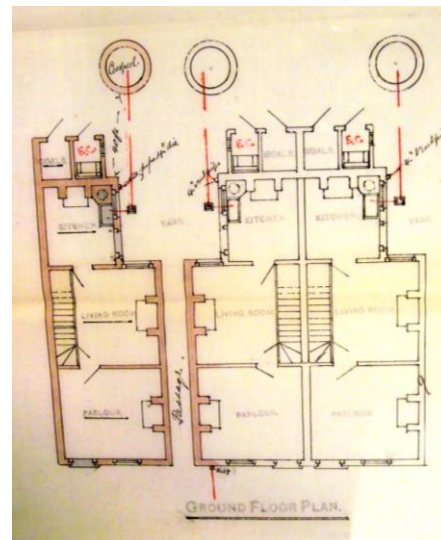

BP: 12.12.1889.

Plans for WJ Webb of Brookfield, Mill Rd.

Plans by: Ambrose Miller, Builder, Belgrave Rd



### 1891c

Missing, Richard	Coal Carman	28	Hd	Cambs, Fulbourn
Missing, Elizabeth		36	Wife	Suffolk
Missing, Sidney Stanley		3	Son	Cambridge

### 1901c

Missing, Richard	Coal Carter	37	Hd	Cambs, Fulbourn
Missing, Elizabeth		45	Wife	Suffolk, Bury St Edmunds
Missing, Sidney	Telegraph Messenger	13	Son	Cambridge
Missing, Leonard		8	Son	Cambridge



### 1891c

Hull, James	Mason	27	Hd	Lincs, Stamford
Hull, Alice		30	Wife	Lincs, Gosberton
Hull, Ethel		11 months	Dau	Cambridge

### 1901c

Wade, John	Foreman Builders Yard	41	Hd	Rutland, (Belton?)
Wade, Alice		40	Wife	Nothants, Easton
Wade, John		10	Son	Cambs, Cherry Hinton
Wade, Gertrude		9	Dau	Cambs, Cherry Hinton



### 1891c

Webb, William	Living on his own (Means?)	68	Hd	London,
Webb, Ruth		29	Wife	Cambs Harston
Webb, William		2	Son	Cambridge

### 1901c

Chapman, John	General Labourer	48	Hd	Cambs, Wilburton
Chapman, Martha		47	Wife	Cambs, Cherry Hinton
Chapman, Henry	Tin smith	21	Son	Cambs, Cherry Hinton
Chapman, Alfred		9	Son	Cambs, Cherry Hinton
Chapman, Amy		5	Dau	Cambs, Cherry Hinton

### Note: Ruth Webb. Born.1862

1898: Ruth Webb's husband Wm Webb died

1898: Ruth Webb marries Henry Wheeler, b.1846. Carpenter, Cavendish Rd.

1903: Henry Wheeler died

1905: Ruth Wheeler marries Henry Bailey.b.1844. Blacksmith. 1901c: 29 Cockburn St.

1905: Ruth Bailey & Henry Bailey build Hemingford House, Hemingford Rd

# Hemingford Rd: 10-12-14-16-18-20-22-24

## ***Pretoria Terrace***

### **Built:**

**No 24.26: 1881-1884**

**No 20.22: 1887-1891c**

**No 16.18: 1901c-1904**

**No 10.12.14: 1904-1910 LV**

**Owned by: Ned Pamphilon  
(1878 D: 1897 SI)**



Despite the date '1901', the 'Terrace' was built over a 20 year period, starting with No 24 & 26 (1881-1884), and concluding with No 14 (1904-1910).

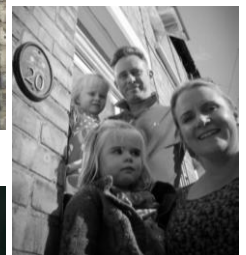
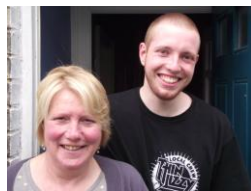

**24**



**'PretoriaTerrace'** celebrates British victories during the Boer War in South Africa.

With Fern Cottages it is one of only two group of houses in the road given a distinctive name, and is a reminder that the British Empire was very much a reality for the early residents of Hemingford Road.

The terrace was built on Building Lots 18 & 19 of the 1878 sale by the Johnson family.



Ned Pamphilon, Builder, of 59 Gwydir St, probably bought both Lots in the original sale – he is recorded as owner of Lot 18 in 1878 ( D: Hemingford Ho), and owned both Lots by 1897 (SI). No 14 had been sold to the occupier, John Curtis, by 1910 ( Land Valuation). The other properties remained tenanted until sold by the Pamphilon family in 1935. At that date the tenants were all long standing, and on weekly tenancies:

<b>No 10: Mr A Alexander</b>	<b>24 Years</b>	<b>£20-12</b>	<b>No 22: Mr CH Harradine</b>	<b>32 Years.</b>	<b>£18-4</b>
<b>No 12: Mr L Fuller</b>	<b>15 Years</b>	<b>£20-16</b>	<b>No 24: Mr ST Harding</b>	<b>? Years</b>	<b>£18-17</b>
<b>No 16: Mr A Wright</b>	<b>30 Years.</b>	<b>£18-17</b>	<b>No 26: Mr A Ward</b>	<b>16 Years</b>	<b>£18-4</b>
<b>No 18: Mr H Holder</b>	<b>35 Years</b>	<b>£18-7</b>			
<b>No 20: Miss A Pottrell</b>	<b>20 Years</b>	<b>£17-6-8</b>			



**No 10. 1910LV:** Moore, Edmund John  
**1911c:**

Ilett, William	Railway Pensioner	59	Hd	Cambs, Upwell
Ilett, Annie M		37	Wife	Cambridge
Ilett, Edward Debnam	Clerk	19	Son	Cambs, Lode
Ilett, John Robert	GPO messenger	16	Son	Cambs, Lode
Ilett, Ivy Lizzie	School	9	Dau	Cambridge



**No 12. 1910LV:** Plumb, John  
**1911c:**

Plumb, John	Carpenter Out of Work	68	Hd	Widower	Cambs, Ickleton
Plumb, Harriett	Housekeeper	64	Cousin s.		Cambridge



**No.14. 1910LV:** Curtis, Arthur John  
**1911c:**

Curtis, Arthur J	Railway Porter	38	Hd		Norfolk, Gt Yarmouth
Curtis, Florence		35	Wife	m. 15yrs	Cambridge
Curtis, Edward	Auctioneers Clerk	15	Son		Cambridge
Curtis, Margaret	School	9	Dau		Cambridge



**No 16. 1904:** Curtis, AJ  
**1911c:**

Wright, Arthur S	GER. Acting Fireman	30			Norfolk, Gt Yarmouth
Wright, Ethel may		30			Cambs, Longstanton
Wright, Arthur G		6			Cambridge



**No 18 1904:** Holder, HJ

**1911c:**

Holder, Harison J	Signalman	36	Hd	Cambridge
Holder, Thyrsa		37	Wife m. 11 yrs	London, Kentish Town
Holder, Harold J	School	10	Son	Cambridge
Holder, Leonard A		3	Son	Cambridge



**No 20 1891c:**

Simpson, Herbert	Foreman Railway	30	Hd	Suffolk Sudbury
Simpson, Alice		28	Wife	Cambridge
Simpson, Horace		8	Son	Cambridge
Simpson, Frank	Scholar	7	Son	Cambridge
Simpson, Reuban	Scholar	5	Son	Cambridge
Simpson, Francis		1	Dau	Cambridge



**No 22 1891c**

Smith, Thomas	29	Hd	Cambridge
Smith, Louisa	25	Wife	Cambridge
Smith, Willie	5	Son	Ramsgate
Smith, Arthur	4	Son	Ramsgate
Smith, Thomas	2	Son	Ramsgate
Smith, Clarence	6 months	Son	Cambridge



**No 24 1884** Hollings, Charles Wm Bookbinder & Postman

<b>1891c:</b> Hollings, Charles W	Bookbinder	42	Hd	Cambridge
Hollings, R(?)		39	Wife	(Herts)
Hollings, Elizabeth	Scholar	11	Dau	Lincs, Belvoir
Hollings, Daisey	Scholar	9	Dau	Cambridge
Hollings, Rosalind	Scholar	7	Dau	Cambridge
Hollings, Kate	Scholar	5	Dau	Cambridge
Hollings, Ernest Charles		2	Son	Cambridge
Hollings, Harold John		10 m'ths	Son	Cambridge



**No 26**

**1884:** Spilsbury, Herbert Railway Servant

**1891c:**

Pilsbury, Herbert	Engine Stoker	40	Hd	(Stafford?)
Pilsbury M(?)		43	Wife	(Stafford?)
Pilsbury, (?)	Scholar	14	Dau	Staff
Pilsbury, Bertie	Scholar	4	Son	Cambridge
Pilsbury, Alice	Scholar	9	Dau	Cambridge
Pilsbury (?)	Scholar	7	Dau	Cambridge
Pilsbury, Willie	Scholar	5	Son	Cambridge
Pilsbury, George		6 m'ths	Son	Cambridge



# Hemingford Rd: 28-30



**Built: 1879-1884**

**Owner:1897 SI – Alexander Strang**

**[1897 SI: Alexander Strang also owns 36-38.40-42.  
Lives at No 28 in 1901. By 1904-1911c at No 25]**



## No.28

**1884:** Smith, George Carpenter

### 1891c

Harding, George	Labourer	45	Hd	Cambridge
Harding, Mary Ann		43	Wife	Cambridge
Harding, William		20	Son	Cambridge
Harding, Thomas		18	Son	Cambridge
Harding, George		14	Son	Cambridge
Harding, Sarah J		8	Dau	Cambridge

### 1901 c

Strang, Alexander	Forester Retired	71	Hd	Scotland
Strang, Ann		67	Wife	Scotland



## No. 30

**1884:** Page, Stephen Cab Inspector

### 1891c

Dawkins, Alfred	Stomemason	35	Hd	Cambs Chesterton
Dawkins, Ada L	Laundress	34	Wife	Cambs Linton
Dawkins, HJ (?)		10	Son	Cambs Chesterton
Dawkins, Emily Mabel		9	Dau	Cambs Chesterton
Dawkins, Lily Sarah		7	Dau	Cambridge
Dawkins, Ada L		6	Dau	Cambridge
Dawkins, Florence M		4	Dau	Cambridge
Dawkins, Mabel S		1	Dau	Cambridge

# Hemingford Rd: 32-34

**Built: 1892 BP-1895**

**Owner:**  
**David Crown , Builder ,**  
**Catherine St & Mill Rd**  
**(1892 BP)**

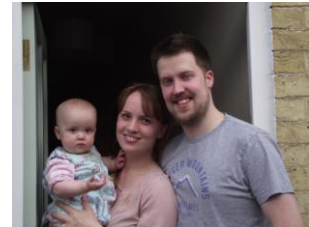

**BP: 15.12.1892**

**Plans for 2houses for David Crown, Catherine St & Mill Rd Plans by: Crown, David**

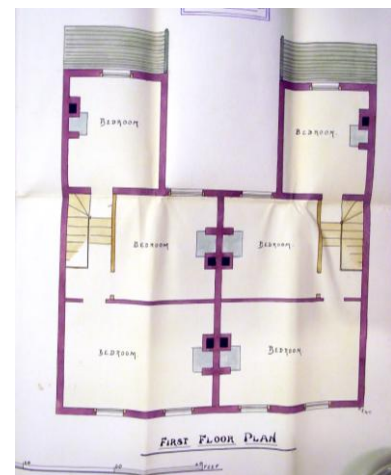
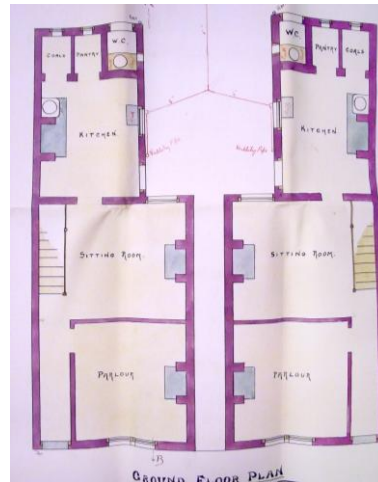

## No 32

**1895:** Sayer, Daniel Bricklayer

**1901 c**

Sayer, Daniel	Builders Foreman	39	Hd	Norfolk, Thelthorpe
Sayer, Edith		34	Wife	Norfolk, Noth Walsham
Sayer, Charles		12	Son	Norfolk, Noth Walsham
Sayer, Ethel		11	Dau	Norfolk, Noth Walsham
Sayer, Sidney		8	Son	Norfolk, Noth Walsham

**Note: 1911c: Daniel & Edith Sayers are living at No 23 Hemingford Rd.**



## No 34

**1895:** Hull, James Stomemason

**1901 c**

Ridgeon, William	Baker Lad	29	Hd	Notts, Newark
Ridgeon, Dorcas		30	Wife	Cambs, Iseham
Ridgeon, Leslie		4	Son	Cambridge Barker,
Barker, Alfred	Railway Engine Cleaner	21	Boarder	Saffron Walden



# Hemingford Rd: 36-38

**Built: 1879-1884**

**Owner: Alexander Strang (1897 SI)**

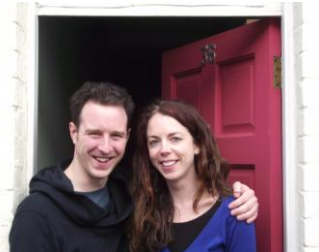

## No 36

**1884:** Thorogood, Joseph      Signal Fitter

### 1891 c

Thorogood, Joseph	Railway Servant	40	Hd	Cambs, Newmarket
Thorogood, Sarah		33	Wife	Cambridge
Thorogood, Flora	Scholar	14	Dau	Cambridge
Thorogood, Rose	Scholar	12	Dau	Cambridge
Thorogood, Joseph	Scholar	10	Son	Cambridge
Thorogood, William	Scholar	8	Son	Cambridge
Thorogood, Arthur	Scholar	5	Son	Cambridge
Thorogood, Lillian	Scholar	2	Dau	Cambridge
Thorogood, Leonard		6 m'ths	Son	Cambridge
Warrack, James	Carpenter	75	F'r in Law	Suffolk Dunwich



## No 38

**1884** Hubbard, Stephen      Foreman Goods Porter

### 1891 c

Hubbard, Stephen	Foreman on Railway	54	Hd	Norfolk, Norwich
Hubbard, Mary Ann		49	Wife	Norfolk, Norwich
Hubbard, Stephen	Carman on Railway	28	Son	Norfolk, Norwich
Hubbard, R(?)	Domestic Servant	19	Dau	Cambridge
Hubbard, Florence	Domestic Servant	16	Dau	Cambridge
Hubbard, Ethel	Scholar	9	Dau	Cambridge



# Hemingford Rd: 40-42



**Built: 1879 -1884**

**Owner: Alexander Strang**  
**(1897 SI).**

**See: No 28.30; 36.38**



42



## No 40

**1884:** Gipp, Alexander    Gardener

**1887:** Beeken, George    Bricklayer

## 1891 c

Becken, Sarah	38	Wife	Lincs (?)
Barlow, Martha	62	Mother ( Widow)	Lincs Holbeach Hurn



## No 42

**1884:** Harvey, James    Carpenter

## 1891 c

Harvey, James	Carpenter	62	Hd	Norfolk Walsingham
Harvey, Sarah		66	Wife	(?)
Harvey, Alfred E		26	Son	Norfolk (?)
Harvey, Ethel	Domestic Servant	20	Dau	Cambs, Trumpington

# Hemingford Rd: 44-46-48-50

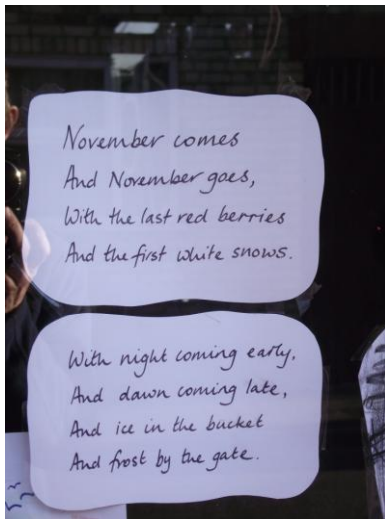

**Built: 1904 'Houses Building'**

**Owner: Ralph Starr, Photographer, Burleigh St (1903 D)**



**44**

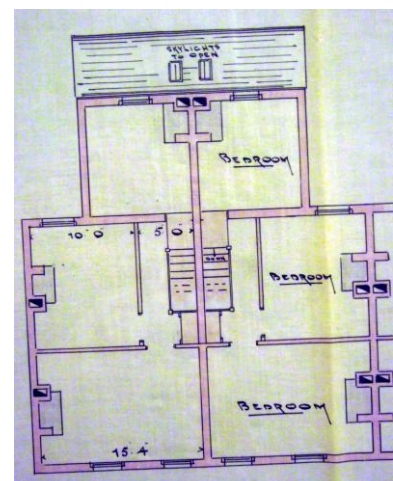
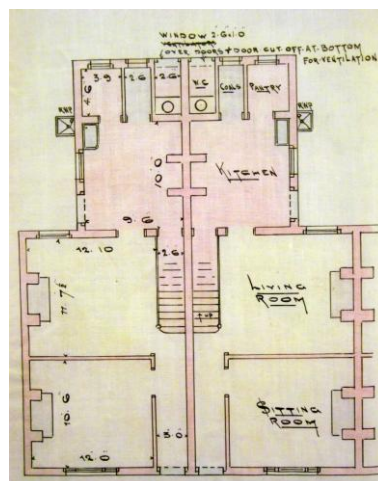
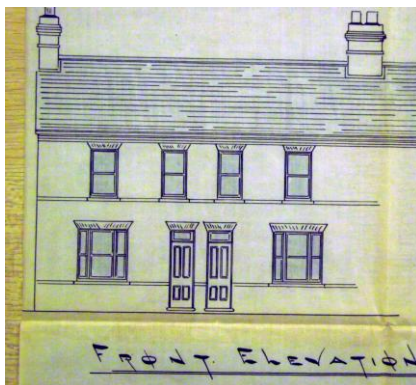

**BP: 18.6.1903 For Starr, R: 74 Burleigh St**

**Plans by: Porter,; 49 City Rd**



#### **NO 44**

**1910 LV:** Coe, Charles

#### **1911 c**

Coe, Charles	Postman	30	Hd	Cambridge
Coe, Annie		31	Wife m. 6yrs	Cambridge
Coe, Vida		5	Dau	Cambridge
Coe, Sylvia		2	Dau	Cambridge



#### **No 46**

**1910 LV:** Rudd, William Leonard

#### **1911 c**

Rudd, Leonard	Railway Clerk	37	Hd	Norfolk, Norwich
Rudd, Ethel		28	Wife m. 4 yrs	Cambridge
Rudd, Eric		3	Son	Cambridge
Rudd, Mary		0	Dau	Cambridge



#### **No 48**

**1910 LV:** Saunders, Wm

#### **1911 c**

Sunders, William	Police Constable	31	Hd	Yorks, Methley
Sunders, Jessie		31	Wife	Cambridge
Sunders, William		3	Son	Cambridge
Wallage, John	Police Constable	25	Boarder	Suffolk, Wood Ditton



#### **No 50**

**1910 LV:** Brown, Michael Robert

#### **1911 c**

Hart, Charlotte	Laundress	55	Hd widow	Cambs, Reach
Hart, Charles	Railway Engine Stoker	26	Son	Cambs, Teversham
Hart, Eliza		14	Dau	Cambs, Teversham
Peach, Charles	Railway Carriage Examiner	26	Boarder	Hunts, Diddington
Coulson, James	Railway Carriage Examiner	23	Boarder	Northants, Polebrook



# Hemingford Rd: 52



Built: 1901 BP – 1911c

Rebuilt: ?

Owner:

1901 BP – Fred Lucas

1910 LV – Mr Stevans

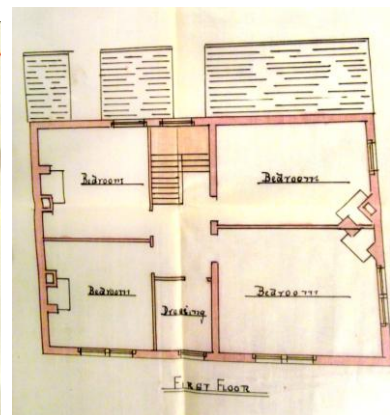
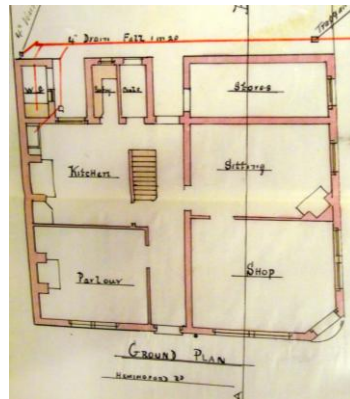

BP: 18.07.1901. Plans for House & Shop for Lucas, Fred: 4. Prory Terrace, Huntingdon Rd  
Plans by: Slingsby (A): 31. Union Terrace

1904: No Record

1911 c

Searle, Frederick W	Grocer own account	41	Hd	Cambs, Whittlesea
Searle, Mary		41	Wife m. 17yrs	Cambs, Littleington
Searle, Harold	School	16	Son	Cambridge
Searle, Douglas	School	7	Son	Cambridge

**No 52: 'Wigy' Searle ran a 'Grocer's and General Dealers' on the corner of Hemingford Road and St Philips Road :**

*'He was so called because he had a toupee!  
He was very adept at making cone bags with blue sugar paper, into which he measured a bit of sugar or whatever – because nothing came in packages. Nothing was packed in those days. So he had big tins of biscuits, and you could often buy a cone of broken biscuits'.*

**Jean Turner ( nee Holder)**

# Hemingford Rd: 54-56-58-60-62-64-66



**Built: 54-60: 1901c-1904**

**62-64: 1904**

**66: 1910 BP – 1911c**

**Owner: 54 -64: 1902 AJ Watson, Builder, (BP)**

**54-66: 1910 Thomas Hayward, (LV)**



**62**

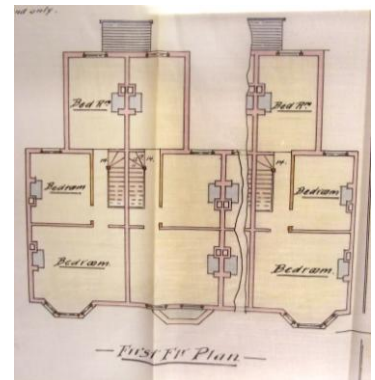
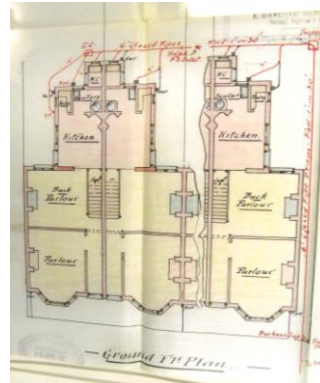

**BP: 17.4.1902 Plans for 6 Houses for Watson, AJ: Mawson Rd**

**Plans by: Watson, AJ: Builder,**

**No 54**

**1904: Jackson, Luke**

**1910 LV: White, Horace**

**1911 c**

Faircliff, Ernest	Postman	33	Hd	Cambs, Burwell
Faircliff, Louisa		33	Wife m.10yrs	France
Faircliff, Charles Ernest		5	Son	Cambs, Burwell
Faircliff, Albert		3	Son	Cambs, Burwell
Faircliff, Agnes Louise		3	Dau	Cambridge





### No 56

**1904:** Freeman, Robert

**1910 LV** Atkinson, John Thomas

### 1911 c

Atkinson, Florence	Wife m.14yrs	42	Warwickshire, Coventry
Atkinson, Ernest E	Son	8	Essex, Bishop's Stortford
Atkinson, Ethel M	Dau	6	Cambs, Bassingbourne
Atkinson, Albert Bates	Son	2	Cambridge



### No 58

**1904:** Buck, Mrs

**1910 LV** Buck, Annie

### 1911 c

Collis, Henry	India Army Retired Pensioner	58	Hd	Cambridge
Collis, Grace E		51	Wife m. 22yrs	Jhanis, India
Collis, Roy N		13	Son	Ferozepore, India



### No 60

**1904:** Lucas, Mark

**1910 LV:** Covill, Herbert

### 1911 C

Covill, Herbert	Stoker. Saxon Cement Company	31	Hd	Cambs, Trumpington
Covill, Elizabeth		30	Wife m. 7yrs	Suffolk, Bury St Edmunds
Covill, George E		6	Son	Cambridge
Covill, Herbert A		5	Son	Cambridge
Covill, Florence P		0	Dau	Cambridge



### No 62

**1904:** Two Houses Buiding

**1910 LV:** Farrow, Mr EW

### 1911c

Cranfield, Walter				
Cranfield, Walter	Linesman.	30	Hd	Cambridge
	Post Office Telegraphs			
Cranfield, Maud		28	Wife m. 6yrs	Cambridge
Cranfield, Hilda		5	Dau	Suffolk, Newmarket
Cranfield, Maud		2	Dau	Suffolk, Newmarket





## No 64

**1904:** Two Houses Building

**1910 LV:** Fox, Mr

**1911c**

Fox, Annie 28 Wife Cambridge

Fox, Aubrey 4 Son Cambridge

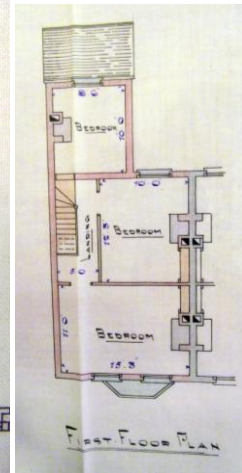
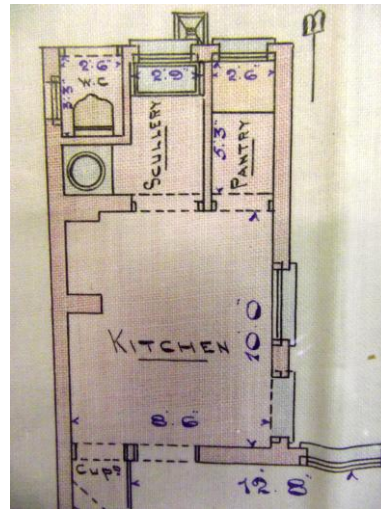
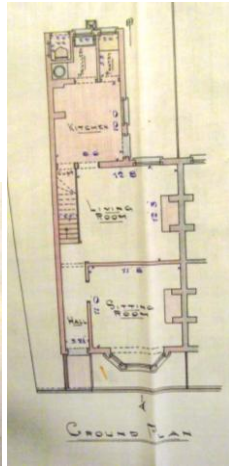

**BP: 24.2.1910 Plans for 1 House for Hayward, Thomas: Regent St**  
**Plans by: Sharman, R: Tenision Rd (B)**



## No 66

**1904:** No Record

**1901c**

West, Christopher H	Railway Clerk	35	Hd	Lincs, Spalding
West, Edith M		35	Wife m. 14yrs	Lincs, Lincoln
West, Winifred	School	13	Dau	Lincs, Spalding
West, Dorothy	School	8	Dau	Lincs, Pinchbeck



# Hemingford Rd: 68-70-72-74-76-78-80-82-84



**Land sold for all properties:  
1906: J Sturton to D Crown (D).  
For £225**

**Built:  
1906 D -1910 (LV)**

**Owner:  
1906: David Crown**

**1921:  
D Crown sells  
No 68 to W Lander  
for £300**

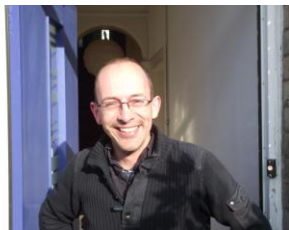



BP: 25.10.1906 Plans for David Crown, 42. Warkworth St

Plans by: David Crown

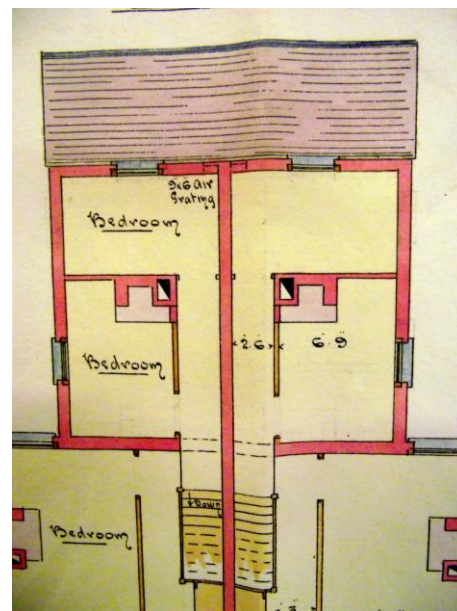
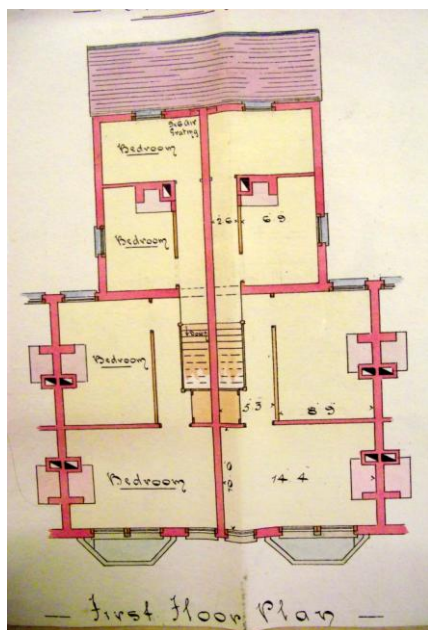
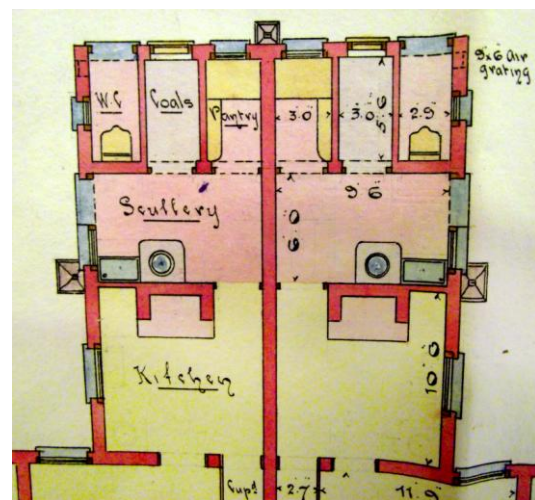
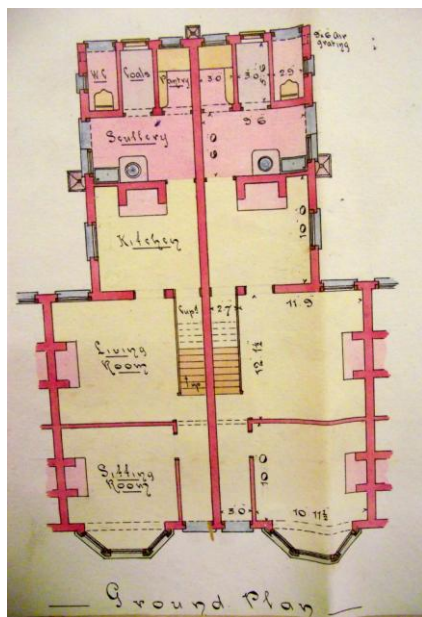
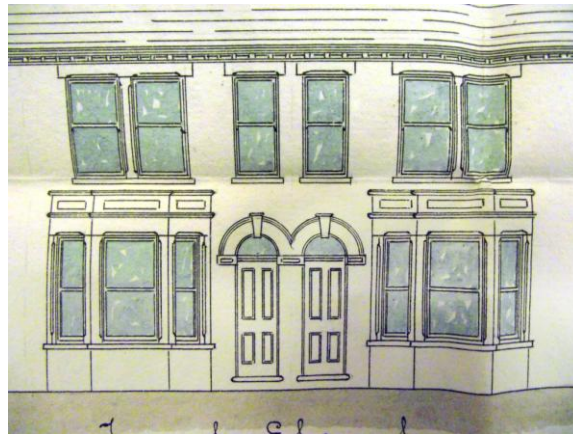

Note: 4 Bedrooms.





### No 68

**1910 LV:** Ablett, John

### 1911c

Ablett, John	Engine Driver. GER	45	Hd	Cambridge
Ablett, Elizabeth		44	Wife m. 17yrs	Italy
Ablett, Dorothy	Dressmaker	15	Dau	Suffolk, Bury St Edmunds
Ablett, Elizabeth	Milliner	14	Dau	Suffolk, Bury St Edmunds
Ablett, Edward		7	Son	Cambridge
Ablett, John		6	Son	Cambridge
Ablett, Stanley		5	Son	Cambs, Ely

**Note:** 1910 William Lander lives at No 70 (LV)

1911c William Lander living at 73 St Philips Road.

1921 William Lander, Engine Driver, buys No 68 from David Crown: £300 (D:No68)



### No 70

**1910 LV:** Lander, William Elbourne

### 1911c

Nunn, Edward	Railway Guard. GER	32	Hd	Suffolk, Kentford
Nunn, Ellen		26	Wife m.5 yrs	Cambs, Wisbech
Nun, Derrick		1	Son	Cambs, Wisbech



### No 72

**1910 LV:** Redhead, John

### 1911c

Driscoll, William	Naval Pensioner. Cleaner GPO	40	Hd	London, St Georges in the East
Driscoll, Caroline		40	Wife m. 8 yrs	Surrey, Worplesdon
Driscoll, James Wm Horne		0	Son	Hants, Portsmouth
Driscoll, Helen C		7	Dau	Hants, Portsmouth Milton
Driscoll, Bessie E		4	Dau	Hants, Portsmouth Milton



### No 74

**1910 LV:** Morrell, Henry

### 1911c

Morrell, Henry	Railway Guard	51	Hd	Ipswich
Morrell, Charlotte		48	Wife m. 29 yrs	Cambridge
Morrell, George	House Painter & Decorator	25	Son .	Cambridge
Morrell, Florie	Layteress ( Waiteress?)	23	Dau	Cambridge
Morrell, William	Stone Mason	20	Son.	Cambridge
Morrell, Arthur	Taylor	16	Son	Norfolk, Kings Lynn
Morrell, Nellie	Apprentice Dressmaker	14	Dau	Norfolk, Kings Lynn
Morrell, Dollie	School	11	Dau	Cambridge

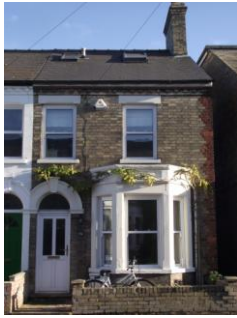

### No 76

#### 1911c

Cobbold, Victoria 59 Hd Widow Cambridge



### No 78

#### 1910 LV: Parry, Albert

#### 1911c

Lear, Frederick Stonemason 45 Hd London, Kennington  
Lear, Gertrude 31 Wife m.8yrs Essex, Colchester



### No 80

#### 1910 LV: No Record

#### 1911c

Morley, Alfred Charles Railway Clerk, GER 27 Hd Cambridge  
Morley, Florence M 25 Wife Cambridge



### No 80

#### 1910 LV: Moon, James

#### 1911c

Moon, James Joiner 54 Hd Cheshire, Macclesfield  
Moon, Rebecca 54 Wife m. 33yrs Cambs, Toft  
Moon, Alec Teacher 19 Son Cambridge  
Moon, Daisy E School 16 Dau Cambridge  
Moon, Harold Houghton School 11 Son Cambridge



### No 84

#### 1911c

Routledge, Thomas Fishmonger Manager 30 Hd Cambs, March  
Routledge, Annie 33 Wife m 8yrs London, Bloomsbury  
Routledge, Gladys A 7 Dau Essex, Ilford  
Routledge, Doris 4 Dau Mdx, West Ealing  
Routledge, Florence K 2 Dau Essex, Colchester

# Hemingford Rd: 100-102-104

**Built: 1905 (D:100)**

**Owner: 1905 Ralph Starr, Photographer, Burleigh St  
(D:100)**

**Sold: 1906 No 100 - £245 (D:100)**



## 104

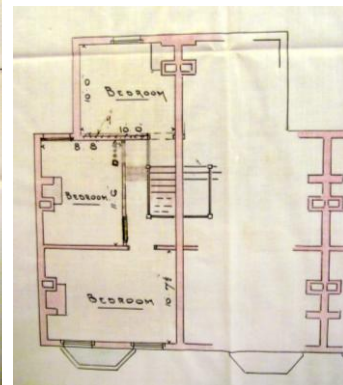
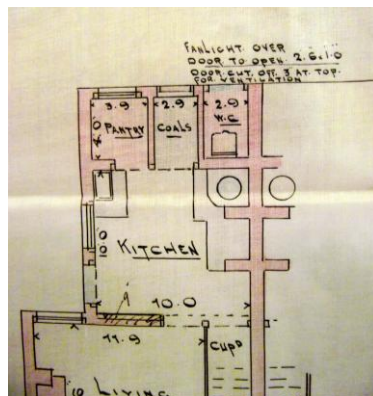
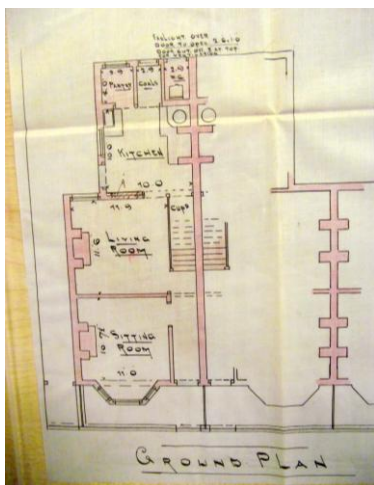

**BP 28.9.1905 Plans for: J Starr, 58 Argyle St Plans by: Starr, James, 58 Argyle St**





### No 100

**1910 LV: Starr, James**

**1911 c**

Starr, James	Carpenter & Joiner	42	Hd	Cambs, Ely
Starr, Ellen		40	Wife m 15yrs	Essex, Waltham Abbey
Starr, Gladys	School	14	Dau	Cambridge
Starr, Victoria	School	10	Dau	Cambridge
Starr, Stanley	School	8	Son	Cambridge



### No 102

**1910 LV: Lambert, John Wm**

**1911 c**

Lambert, JW	Joiners Sawyer	47	Hd	Lincs, Peterborough
Lambert, Rose		46	Wife m. 19yrs	Norfolk, Feltwell
Lambert, Flossie	Dress Maker	18	Dau	Cambridge
Lambert, Horace	Clerks Printer	16	Son	Cambridge
Lambert, Gladys	Book Binder	15	Dau	Cambridge
Lambert, Robert	School	11	Son	Cambridge



### No 104

**1910 LV: Bailey, Thomas Frederick**

**1911 c**

Bailey, Thomas F	Locomotive Shedman	40	Hd	London, Camberwell
Bailey, Janet		45	Wife m. 20yrs	Brecknockshire,
Bailey, Thomas	Railway Fitters	App 17	Son	London, Stratford
Bailey Janet E	Shop Girl	15	Dau	London, Stratford

## Hemingford Rd: 106-108



**Built: 106: 1901(C)**  
**108: 1899 (BP) - 1901 (C)**  
**Owner: 1899 Alfred & Walter Morley**

**Ebor Cottage & Thriplow Cottage**



**BP: 20.04.1899**  
**Plans for:**  
**Morley, Alfred,**  
**Morley, Walter.**  
**AM: Argyle St.**  
**WM: Mill Rd.**  
**Plans by:**  
**H E, Ambrose**  
**Mawson Rd.**

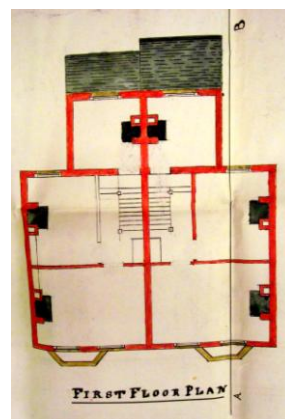
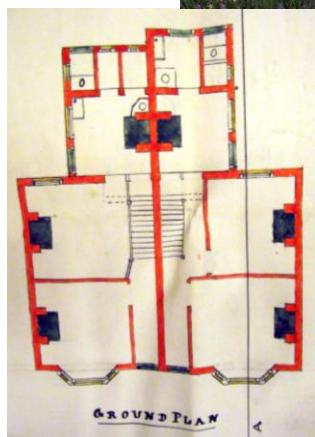

**1901c: Building**  
**1904: Wade, William**  
**1910 LV: Hard, Ernest Joseph ( Builders Foreman 1913)**  
**1911c: Hard, Annette** 29 Wife Cambridge  
**Hard, Cyril** 1 Son Cambridge  
**German, Annie** Drapers Assistant 21 Sister in Law Cambridge

**No 106**



**1901 c: Morley, Alfred J** House Decorator 45 Hd Cambs, Fulbourne  
**Morley, Elizabeth** 47 Wife Cambs, Thriplow  
**Morley, Albert** Railway Clerk 22 Son Cambridge  
**Morley, Alice** 19 Dau Cambridge  
**Morley, Alfred** Railway Clerk 17 Son Cambridge  
**Morley, William** Railway Clerk 15 Son Cambridge  
**Morley, Lily** Mothers Help 13 Dau Cambridge  
**Morley, Rosie** 13 Dau Cambridge  
**Morley, Hilda** 11 Dau Cambridge  
**Morley, Bertha** 8 Dau Cambridge

**No 108**

**Hemingford Rd: 106-108**



**Built: 106: 1901(C)  
108: 1899 (BP) - 1901 (C)  
Owner: 1899 Alfred & Walter Morley**

**Ebor Cottage & Thriplow Cottage**



**BP: 20.04.1899  
Plans for:  
Morley, Alfred,  
Morley, Walter.  
AM: Argyle St.  
WM: Mill Rd.  
Plans by:  
H E, Ambrose  
Mawson Rd.**

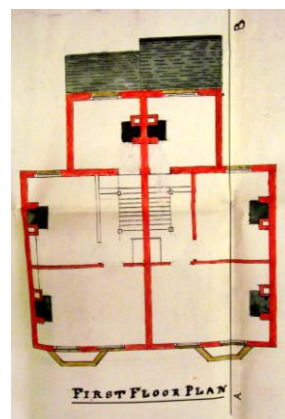
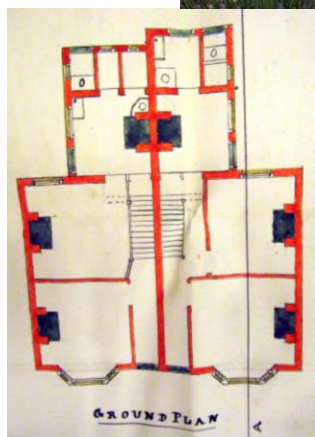

**1901c: Building**  
**1904: Wade, William**  
**1910 LV: Hard, Ernest Joseph ( Builders Foreman 1913)**  
**1911c: Hard, Annette** 29 Wife Cambridge  
Hard, Cyril 1 Son Cambridge  
German, Annie Drapers Assistant 21 Sister in Law Cambridge

**No 106**



**No 108**

**1901 c: Morley, Alfred J** House Decorator 45 Hd Cambs, Fulbourne  
Morley, Elizabeth 47 Wife Cambs, Thriplow  
Morley, Albert Railway Clerk 22 Son Cambridge  
Morley, Alice 19 Dau Cambridge  
Morley, Alfred Railway Clerk 17 Son Cambridge  
Morley, William Railway Clerk 15 Son Cambridge  
Morley, Lily Mothers Help 13 Dau Cambridge  
Morley, Rosie 13 Dau Cambridge  
Morley, Hilda 11 Dau Cambridge  
Morley, Bertha 8 Dau Cambridge



# Hemingford Rd: 110-112

**Built: 1897(BP) -1898**

**Owner: 1897: Messers Warren & Humphrey**

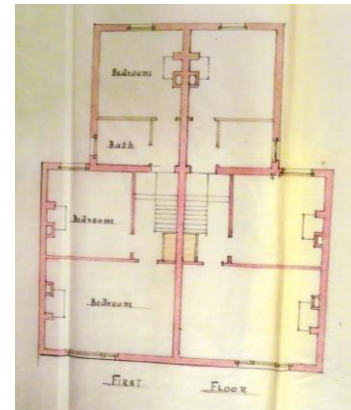
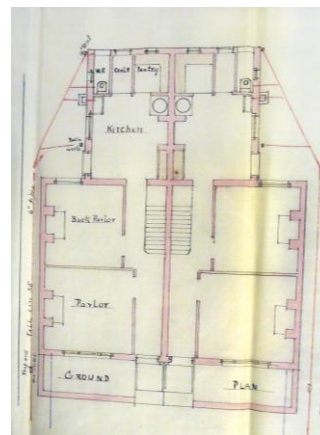
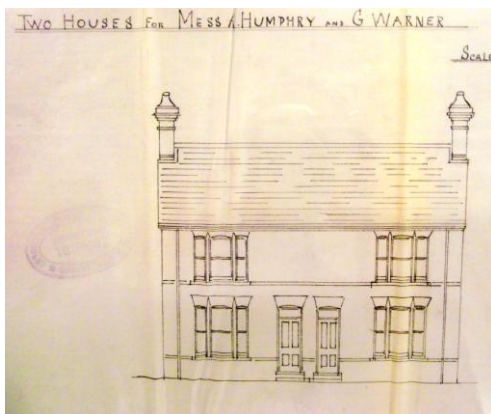

**Note: 3 Bedrooms & Bathroom**

**BP: 20.05.1897 Plans for: 2 Houses for Messers Humphreys & Warner. Plans by: Slingsby, R**



## No.110

**1898:** Humphrey, Arthur Manager, Co-op Grocery Stores  
**1901c:** Humphrey, Arthur Grocers Manager 36 Hd Essex, Kelvedon  
 Humphrey, Deborah 28 Wife Kent,  
 Humphrey, Oliver 7 Dau Hunts, St Ives  
 Humphrey, Emily 6 Dau Hunts, St Ives  
 Humphrey, Mabel 3 Dau Cambridge



## No 112

**1898:** Warren, George Manager, Co-op Drapery Stores  
**1901c:**  
 Wilson, Albert Millwright 52 Hd Hunts, Wyton  
 Wilson, Mary 49 Wife Herts, Hoddesdon  
 Wilson, Ada 25 Dau Essex, Waltham Abbey  
 Wilson, Herbert Ironmongers Assistant 18 Son Herts, Cheshunt  
 Wilson, Harold 10 Son Herts, Cheshunt